

# Infusion Sets

# neria™ infusion sets

The neria™ infusion sets are designed for continuous subcutaneous drug delivery using an external infusion pump. The neria™ infusion sets can be used in different therapy areas and comprise a number of features which support the use of the products for both patient and healthcare professional.

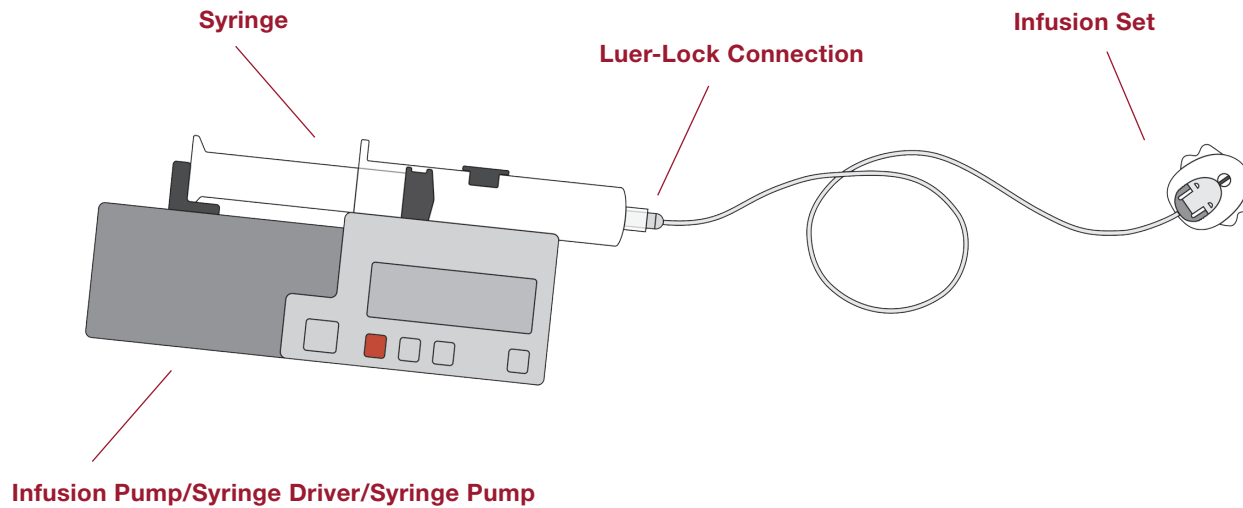

## **Subcutaneous Drug Delivery**

*The delivery of fluid drugs/medication into the subcutaneous tissue/skin via an external infusion pump (syringe driver or syringe pump) and an infusion set over a period of time (up to several days).*

*The system consists of an infusion pump (1), a syringe containing the drug (2) and an infusion set (3).*



# The neria™ infusion set range

The neria™ infusion sets are designed for continuous subcutaneous drug delivery. The neria™ range of products is characterised by high quality and ease of use. This helps provide a high level of user comfort and security which supports therapy compliance.

## neria™ infusion sets offer:

- Thin needle design helping minimise pain during insertion<sup>1,2</sup>
- Skin friendly<sup>3</sup> self-adhesive pad eliminating the use of extra adhesive
- Kink-free, double layer tubing securing constant drug flow
- Low tubing prime volume due to double layer small bore tubing, helps minimise drug wastage<sup>1</sup>



In addition, neria™ products show a lower frequency of skin reactions such as nodules, redness and swelling compared to traditional butterfly lines<sup>1,2</sup>. All neria™ products are tested for stability in use with drugs formulated for subcutaneous infusion related to the treatment of Parkinson's Disease<sup>4</sup>, Primary Immune Deficiency<sup>5</sup>, Thalassaemia<sup>6</sup> and Pain Management<sup>7,8</sup>.

The neria™ infusion set range consists of a number of different configurations offering individual choice for the user dependent on treatment set-up and patient preference - for instance a multi needle set for infusion of large volumes or a soft cannula product for long term infusion (up to 3 days). For detailed product information please refer to the specific product page in this brochure.

# The neria™ infusion set

The neria™ infusion set is a steel needle infusion set designed with ease of use and discreet wear in mind.

The neria™ infusion set is inserted at a 90 degree angle. The simple and quick insertion method supports patient self management and is the obvious choice when using continuous pump therapy.

The neria™ infusion set is specifically tested for use in selected disease areas with drugs formulated for subcutaneous infusion<sup>4,5,6,7,8</sup>.

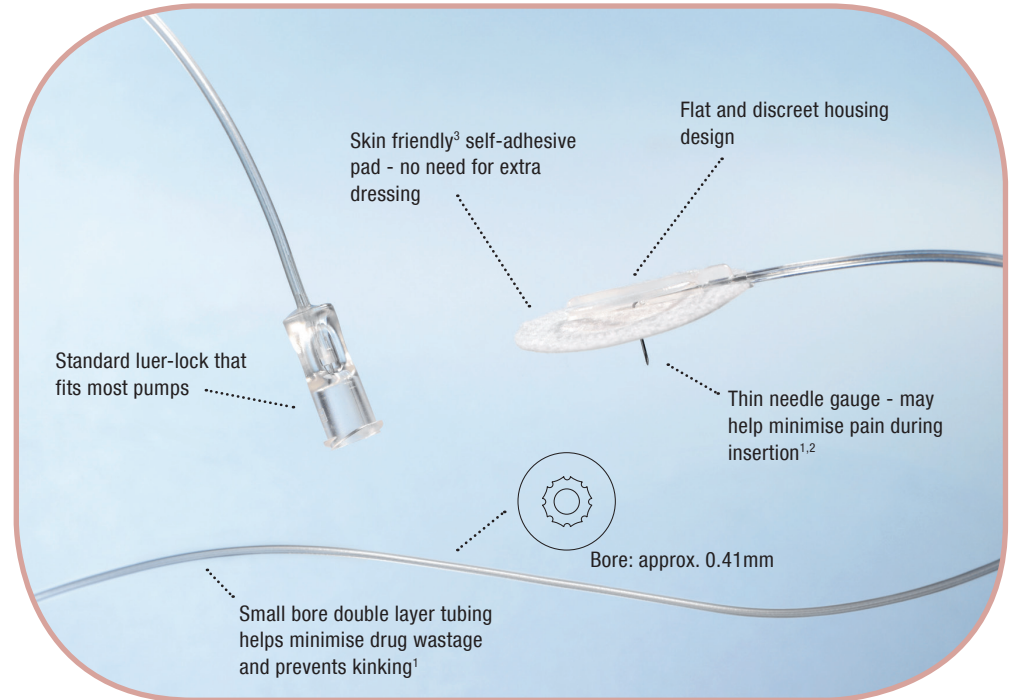

neria™



# The neria™ infusion set and therapy areas

The neria™ infusion set is tested for safe use in the following disease areas with drugs formulated for subcutaneous infusion <sup>4,5,6,7,8</sup>.

## Parkinson's Disease

Parkinson's Disease is a progressive neurodegenerative disorder of the central nervous system.

### Subcutaneous Infusion

Apomorphine is used subcutaneously in the treatment of Parkinson's Disease and patients normally wear the pump and set during the daytime - often 10-12 hours or longer.

### Infusion Set Choice

Using the neria™ infusion set may help improve patient comfort and convenience with features like thin needle design and simple insertion technique, minimising skin reactions often associated with traditional butterfly infusion sets<sup>1,2</sup>. The small bore tubing of the neria™ infusion sets minimises drug waste<sup>1</sup> and may prolong the active day for the patient.

The neria™ infusion set is inserted at a 90 degree angle. The simple and quick insertion method supports patient self management and is the obvious choice when using continuous pump therapy.

## Primary Immune Deficiency

Primary Immune Deficiency is a chronic genetic disorder, where parts of the body's immune system are missing or does not function properly.

### Subcutaneous Infusion

Patients suffering from Primary Immune Deficiency require regular infusions of immunoglobulins which can be administered via the subcutaneous route.

### Infusion Set Choice

Treatment is often carried out at home and for treatment of children, where lower dosages are required, the single needle neria™ infusion set is a obvious choice. The simple insertion technique supports home administration and is an obvious choice in the treatment of children.

# The neria™ infusion set and therapy areas

The neria™ infusion set is tested for safe use in the following disease areas with drugs formulated for subcutaneous infusion <sup>4,5,6,7,8</sup>.

## Pain Management

Pain Management of chronic pain and End of Life care (palliative care).

### Subcutaneous Infusion

In the treatment of pain the subcutaneous route is one way of delivering pain relief medication to the patient. Subcutaneous delivery of pain relief medication may be used when oral medication is no longer an option or in combination with oral medication.

### Infusion Set Choice

For bedridden patients, the simplicity of the neria™ infusion set combined with features like the pre-attached adhesive pad may help improve patient comfort and ease of use for both patient and healthcare provider.

## Thalassaemia

Thalassaemia is an inherited generic blood disorder. The production of normal hemoglobin is partly or completely suppressed.

### Subcutaneous Infusion

The patient requires blood transfusions every 2 - 4 weeks. A significant draw back to this is the accumulation of iron in the patient's body. A way of removing the excess iron from the body is through subcutaneous infusion of deferoxamine mesylate.

### Infusion Set Choice

The infusions are given at night, 5 - 7 days a week. The treatment is primarily performed in the home setting where the thin needle design and the easy use of the neria™ infusion set help make the infusion less painful and intimidating than with a traditional butterfly needle<sup>1,2</sup>.

The pre-attached adhesive may offer increased security during the night time infusions and the simplicity of the neria™ infusion set supports treatment compliance.

# The neria™ infusion set - Product Specifications

|                         |   |
|-------------------------|---|
| <b>Cannula:</b>         | Stainless Steel   |
| <b>Insertion angle:</b> | 90 degrees (straight in)                                  |
| <b>Disconnection:</b>   | No  |
| <b>Needle gauge:</b>    | G27 or G29  |
| <b>Needle lengths:</b>  | 6, 8 or 10 mm   |
| <b>Tubing lengths:</b>  | 60, 80 or 110 cm (23", 31" or 43")                        |
| <b>Adhesive:</b>        | Built-in  |
| <b>Priming volumes:</b> | 60 cm - ~0.10 ml<br>80 cm - ~0.13 ml<br>110 cm - ~0.18 ml |

| Item no. G29 | Tubing length | Needle length |
|--------------|---------------|---------------|
| 78-060-2931  | 60 cm         | 10 mm         |
| 78-060-2936  | 60 cm         | 6 mm          |
| 78-060-2938  | 60 cm         | 8 mm          |
|              |               |               |
| 78-080-2931  | 80 cm         | 10 mm         |
| 78-080-2936  | 80 cm         | 6 mm          |
| 78-080-2938  | 80 cm         | 8 mm          |
|              |               |               |
| 78-110-2931  | 110 cm        | 10 mm         |
| 78-110-2936  | 110 cm        | 6 mm          |
| 78-110-2938  | 110 cm        | 8 mm          |

| Item no. G27 | Tubing length | Needle length |
|--------------|---------------|---------------|
| 78-060-2731  | 60 cm         | 10 mm         |
| 78-060-2736  | 60 cm         | 6 mm          |
| 78-060-2738  | 60 cm         | 8 mm          |
|              |               |               |
| 78-080-2731  | 80 cm         | 10 mm         |
| 78-080-2736  | 80 cm         | 6 mm          |
| 78-080-2738  | 80 cm         | 8 mm          |
|              |               |               |
| 78-110-2731  | 110 cm        | 10 mm         |
| 78-110-2736  | 110 cm        | 6 mm          |
| 78-110-2738  | 110 cm        | 8 mm          |

Each customerbox contains 10 pieces and each shipperbox contains 200 pieces.

# The neria™ detach infusion set

The neria™ detach infusion set is a steel needle infusion set with a disconnect option.

The neria™ detach infusion set is inserted at a 90 degree angle and is suitable for all patient types.

The neria™ detach needles are also sold separately when more frequent change of insertion site is required.

The neria™ detach infusion set is specifically tested for use in selected disease areas with drugs formulated for subcutaneous infusion <sup>4,5,6,7,8</sup>.

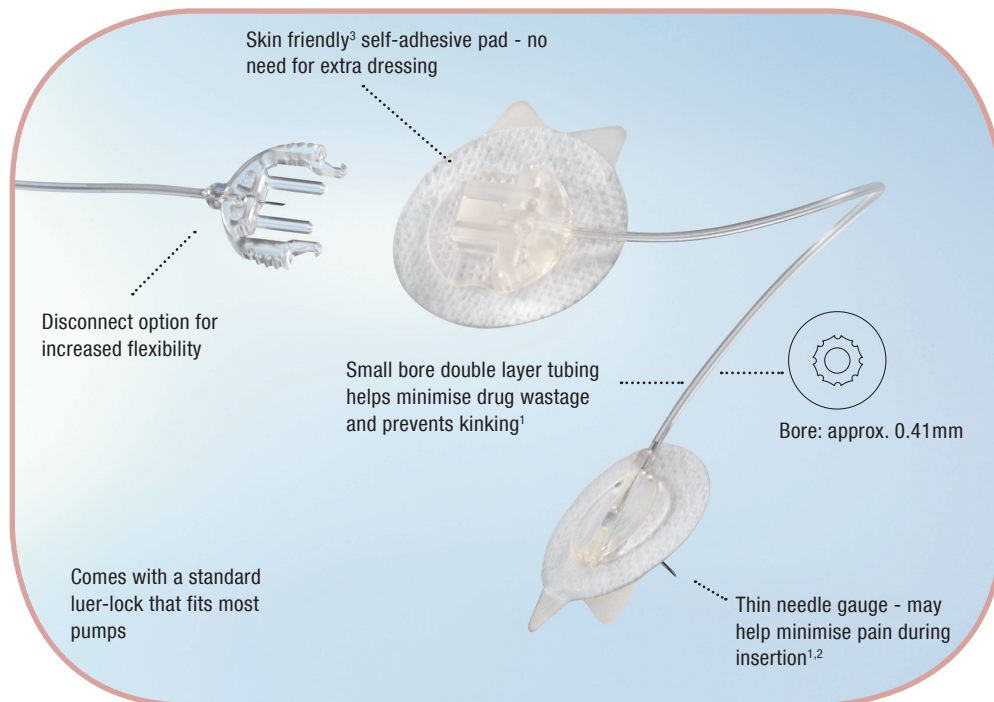

neria™ detach

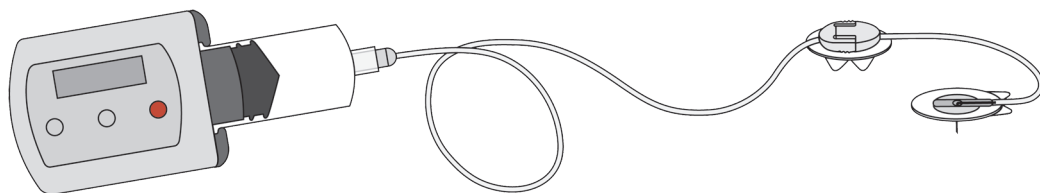



# The neria™ detach infusion set and therapy areas

The neria™ detach infusion set is tested for safe use in the following disease areas with drugs formulated for subcutaneous infusion<sup>4,5,6,7,8</sup>.

## Parkinson's Disease

Parkinson's Disease is a progressive neurodegenerative disorder of the central nervous system.

### Subcutaneous Infusion

Apomorphine is used subcutaneously in the treatment of Parkinson's Disease and patients normally wear the pump and set during daytime - often 10 - 12 hours or longer.

### Infusion Set Choice

The disconnect feature makes the neria™ detach infusion set convenient during long infusion periods. Being able to disconnect brings flexibility to the patient's everyday life. The active patient can conveniently attend various activities such as swimming, shopping or simply taking a shower. Disconnection takes place at a separate adhesive pad, avoiding any contact with the sensitive insertion site.

Due to all its good qualities, such as thin needle design and simple insertion technique, the neria™ detach infusion set may be advantageous for the more active patient.

## Primary Immune Deficiency

Primary Immune Deficiency is a chronic genetic disorder, where parts of the body's immune system are missing or does not function properly.

### Subcutaneous Infusion

Patients suffering from Primary Immune Deficiency require regular infusions of immunoglobulins which can be administered via the subcutaneous route. Treatment frequency varies from patient to patient and treatment is often carried out at home.

### Infusion Set Choice

In some cases the infusion may take longer than the usual 2 - 3 hours, and it may be relevant to disconnect. Especially for treatment of children, where lower dosages are required, the neria™ detach infusion set may be a good choice, because it offers the flexibility of easy disconnection. Contact with the sensitive insertion site is avoided, since disconnection takes place at a separate adhesive pad.

The neria™ detach infusion set is very user-friendly and the simple insertion technique supports home administration and the treatment of children.

# The neria™ detach infusion set and therapy areas

The neria™ detach infusion set is tested for safe use in the following disease area with drugs formulated for subcutaneous infusion<sup>4,5,6,7,8</sup>.

## Pain Management

Pain Management of chronic pain and End of Life care (palliative care).

### Subcutaneous Infusion

In the treatment of pain the subcutaneous route is one way of delivering pain relief medication to the patient. Subcutaneous delivery of pain relief medication may be used when oral medication is no longer an option or in combination with oral medication.

### Infusion Set Choice

To non-bedridden patients, the neria™ detach infusion set offers increased flexibility in the patient's everyday life. The infusion can be easily disconnected at a separate adhesive pad, supporting patient comfort and ease of use for both patient and healthcare provider.

# The neria™ detach infusion set - Product Specifications

|                         |   |
|-------------------------|---|
| <b>Cannula:</b>         | Stainless Steel   |
| <b>Insertion angle:</b> | 90 degrees (straight in)                                  |
| <b>Disconnection:</b>   | Yes   |
| <b>Needle gauge:</b>    | G27   |
| <b>Needle lengths:</b>  | 6, 8 or 10 mm   |
| <b>Tubing lengths:</b>  | 60, 80 or 110 cm (23", 31" or 43")                        |
| <b>Adhesive:</b>        | Built-in  |
| <b>Priming volumes:</b> | 60 cm - ~0.10 ml<br>80 cm - ~0.13 ml<br>110 cm - ~0.18 ml |

| Item no.    | Tubing length | Needle length |
|-------------|---------------|---------------|
| 78-060-2721 | 60 cm         | 10 mm         |
| 78-060-2726 | 60 cm         | 6 mm          |
| 78-060-2728 | 60 cm         | 8 mm          |
| 78-080-2721 | 80 cm         | 10 mm         |
| 78-080-2726 | 80 cm         | 6 mm          |
| 78-080-2728 | 80 cm         | 8 mm          |
| 78-110-2721 | 110 cm        | 10 mm         |
| 78-110-2726 | 110 cm        | 6 mm          |
| 78-110-2728 | 110 cm        | 8 mm          |

| Item no. - Needle Only | Needle length |
|------------------------|---------------|
| 75-000-2721            | 10 mm         |
| 75-000-2726            | 6 mm          |
| 75-000-2728            | 8 mm          |

Each customerbox contains 10 pieces and each shipperbox contains 200 pieces.

# The neria™ multi infusion set

The neria™ multi infusion set line is a series of multi-furcated steel needle infusion sets designed for subcutaneous infusion of immunoglobulins (IgG) for the treatment of Primary Immune Deficiency.

The neria™ multi infusion sets combine the known user benefits of the neria™ infusion set with a number of multi needle infusion sets for delivery of large volumes of immunoglobulins over a short period of time (i.e. 1 - 2 hours).

The neria™ multi infusion sets are available as bi-, tri-, or quad-furcated sets.

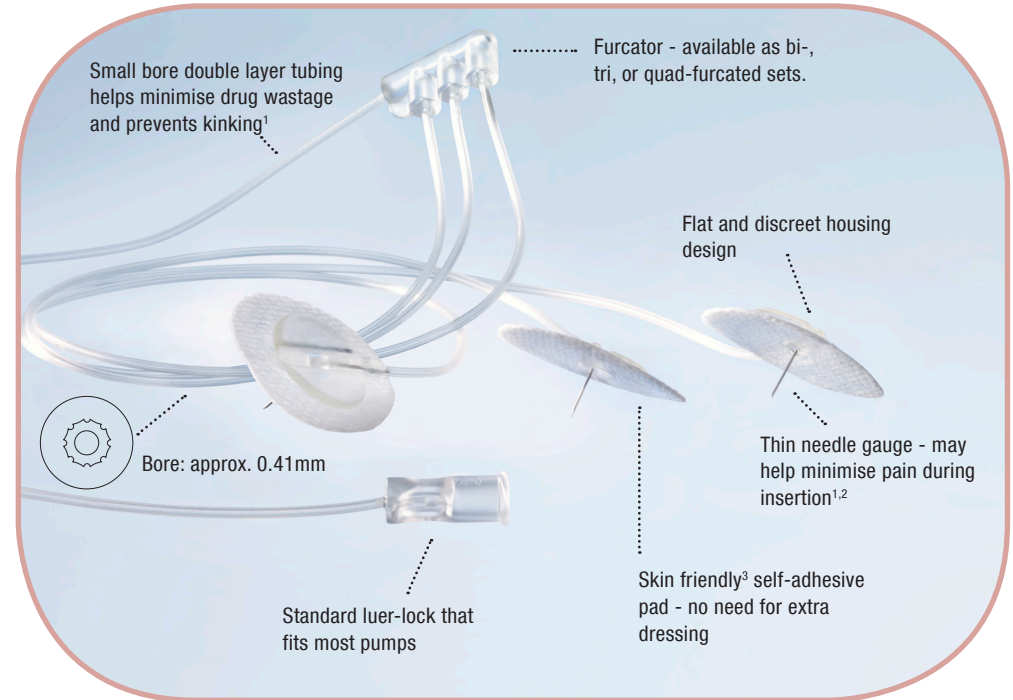

neria™ multi

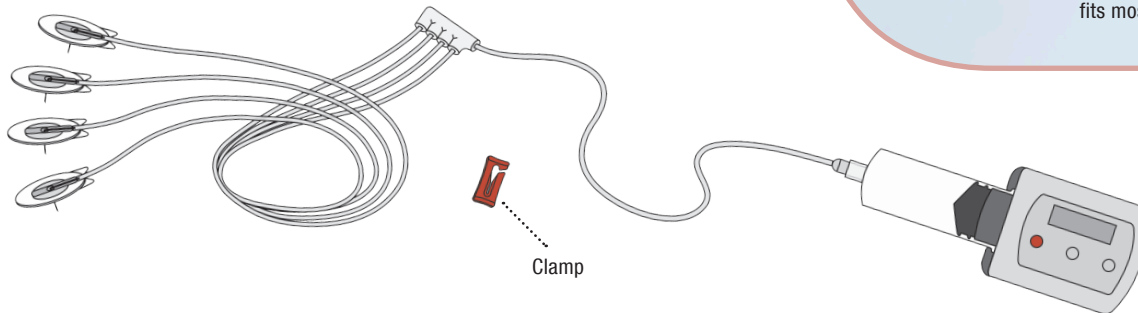

# The neria™ multi infusion set and therapy area

The neria™ multi infusion set is tested for safe use in the following disease area with drugs formulated for subcutaneous infusion<sup>4,5,6,7,8</sup>.

## Primary Immune Deficiency

Primary Immune Deficiency is a chronic genetic disorder, where parts of the body's immune system are missing or does not function properly.

### Subcutaneous Infusion

Patients suffering from Primary Immune Deficiency require regular infusions of immunoglobulins (IgG) which can be administered via the subcutaneous route. Treatment frequency varies from patient to patient and patients are trained to do subcutaneous IgG infusion independently at home.

### Infusion Set Choice

The infusions often require a large amount of drug delivered over a short period of time, in which case it may be necessary to apply an infusion set with multiple infusion sites.

The neria™ multi infusion sets combine the known user benefits of the neria™ infusion set with a number of multi needle infusion sets for delivery of large volumes of immunoglobulins over a short period of time (i.e. 1 - 2 hours).

The choice between 2 (bi), 3 (tri) or 4 (quad) needles allows the healthcare provider to determine the dosage of the medication per site in accordance with the drug specifications.

Using multi-furcated infusion sets usually reduces the infusion time, and the self-adhesive pads, simple insertion technique and less tubing tangle may provide a high level of user comfort, which may enhance therapy compliance. The small bore double layer tubing helps minimise drug wastage and priming volume<sup>1</sup> i.e. treatment cost.

The neria™ multi infusion set has been drug compatibility tested with the most commonly used immunoglobulins, Subcuvia™, Vivaglobulin™, Hizentra™, and Gammanorm™.

# The neria™ multi infusion set - Product Specifications

|                         |   |
|-------------------------|---|
| <b>Cannula:</b>         | Stainless Steel   |
| <b>Insertion angle:</b> | 90 degrees (straight in)  |
| <b>Disconnection:</b>   | No  |
| <b>Needle gauge:</b>    | G27   |
| <b>Needle lengths:</b>  | 8, 10 or 12 mm  |
| <b>Tubing lengths:</b>  | Total of 90 cm  |
| <b>Adhesive:</b>        | Built-in  |
| <b>Priming volumes:</b> | Bi-furcated - ~0.36 ml<br>Tri-furcated - ~0.43 ml<br>Quad-furcated - ~0.51 ml |

| Item no.    | Number of needles | Needle length | Number of clamps |
|-------------|-------------------|---------------|------------------|
| 721060-2738 | 2                 | 8 mm          | 1                |
| 721060-2731 | 2                 | 10 mm         | 1                |
|             |                   |               |                  |
| 721060-3738 | 3                 | 8 mm          | 1                |
| 721060-3731 | 3                 | 10 mm         | 1                |
| 721060-3737 | 3                 | 12 mm         | 1                |
|             |                   |               |                  |
| 721060-4738 | 4                 | 8 mm          | 2                |
| 721060-4731 | 4                 | 10 mm         | 2                |
| 721060-4737 | 4                 | 12 mm         | 2                |

Each customerbox contains 10 pieces and each shipperbox contains 120 pieces.

# The neria™ soft infusion set

The neria™ soft infusion set is a soft cannula infusion set for angled insertion and can be disconnected at-site.

The cannula and tubing for the neria™ soft infusion set are also sold separately when either cannula or tubing needs to be changed more often.

The neria™ soft infusion set is specifically tested for use in selected disease areas with drugs formulated for subcutaneous infusion<sup>4,5,6,7,8</sup>.

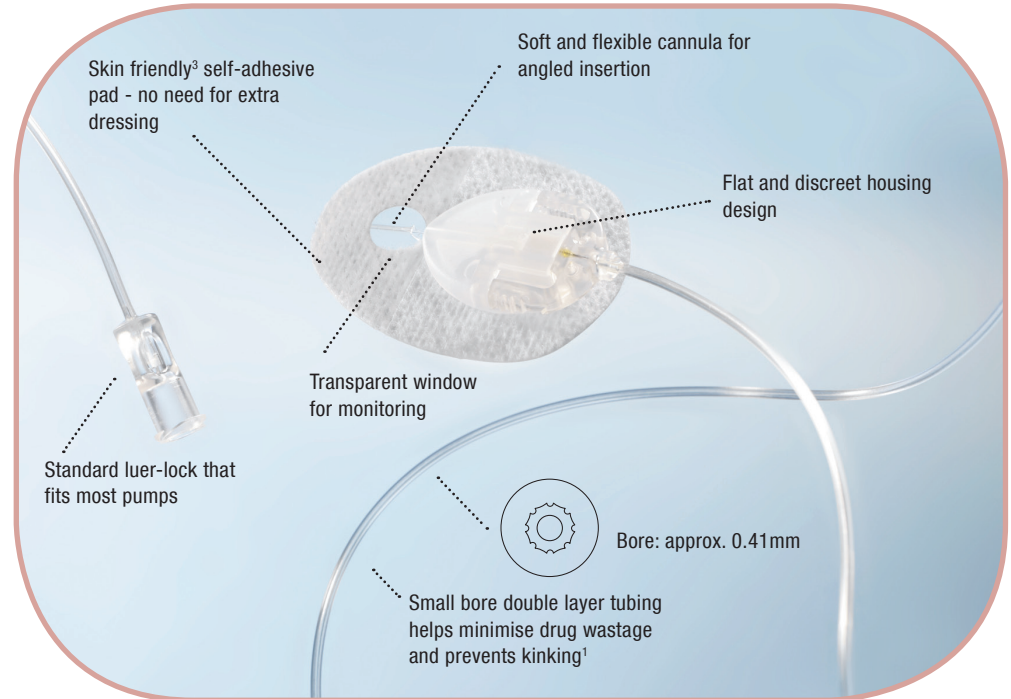

neria™ soft

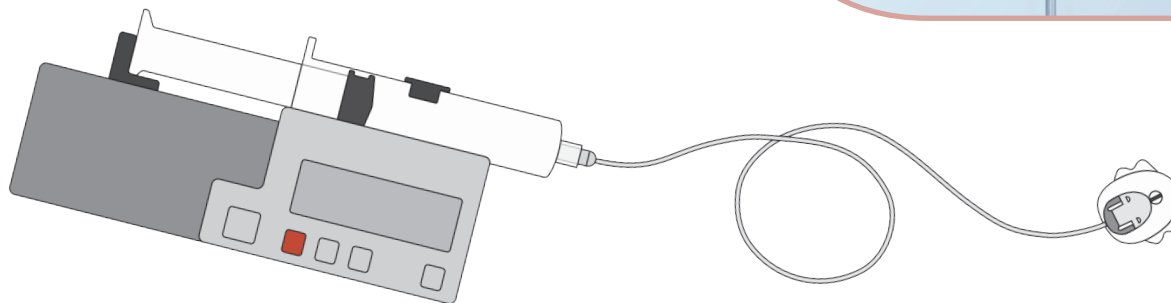

# The neria™ soft infusion set and therapy areas

The neria™ soft infusion set is tested for safe use in the following disease areas with drugs formulated for subcutaneous infusion<sup>4,5,6,7,8</sup>.

## Parkinson's Disease

Parkinson's Disease is a progressive neurodegenerative disorder of the central nervous system.

### Subcutaneous Infusion

Apomorphine is used subcutaneously in the treatment of Parkinson's Disease and patients normally wear the pump and set during the daytime - often 10 - 12 hours or longer.

### Infusion Set Choice

The soft and flexible cannula of the neria™ soft infusion set may provide a more comfortable wear time for some patients. The thin needle design and the simple insertion technique may further help improve patient comfort and convenience.

Being easily disconnected, the neria™ soft infusion set offers the patient the possibility to lead an active life despite the disease. The infusion set can be disconnected for a short period of time to allow the patient to perform activities like swimming, shopping, etc.

The small bore tubing of the neria™ soft infusion set minimises drug wastage<sup>1</sup> and may prolong the active day for the patient.

## Primary Immune Deficiency

Primary Immune Deficiency is a chronic genetic disorder, where parts of the body's immune system are missing or does not function properly.

### Subcutaneous Infusion

PID patients require regular infusions of immunoglobulins which can be done via the subcutaneous route. Treatment frequency varies from patient to patient and treatment is often carried out at home.

### Infusion Set Choice

The neria™ soft infusion set is a particularly good choice when the treatment set-up consists of frequent, small dosages. If the infusion is running for several hours, the neria™ soft infusion set offers the patient the flexibility of easy disconnection. The soft and flexible cannula of the neria™ soft infusion set may for some patients provide a more comfortable wear time. The transparent window at the point of insertion allows monitoring of the insertion site without removing the infusion set, which is important when keeping the integrity of the site.



# The neria™ soft infusion set and therapy areas

The neria™ soft infusion set is tested for safe use in the following disease area with drugs formulated for subcutaneous infusion<sup>4,5,6,7,8</sup>.

## Pain Management

Pain Management of chronic pain and End of Life care (palliative care).

### Subcutaneous Infusion

In the treatment of pain the subcutaneous route is one way of delivering pain relief medication to the patient. Subcutaneous delivery of pain relief medication may be used when oral medication is no longer an option or in combination with oral medication.

### Infusion Set Choice

In palliative care, patient comfort is in focus. A soft cannula infusion set is flexible under the skin, and the angled insertion technique of the neria™ soft infusion set makes it suitable for even very lean patients.

The transparent window allows the healthcare provider to monitor the insertion site and helps to identify skin irritations as early as possible.

The disconnect feature and separate tubing parts are useful when changing drug regime or for the mobility of the patient, and may also improve convenience during long infusion periods.

# The neria™ soft infusion set - Product Specifications

|                          |   |
|--------------------------|---|
| <b>Cannula:</b>          | Soft  |
| <b>Insertion angle:</b>  | 20-45 degrees (angled)                                    |
| <b>Disconnection:</b>    | Yes at site   |
| <b>Needle gauge:</b>     | G27   |
| <b>Cannula diameter:</b> | 0.68 mm   |
| <b>Cannula lengths:</b>  | 13 mm or 17 mm  |
| <b>Tubing lengths:</b>   | 60, 80 or 110 cm (23", 31" or 43")                        |
| <b>Adhesive:</b>         | Built-in  |
| <b>Priming volumes:</b>  | 60 cm - ~0.10 ml<br>80 cm - ~0.13 ml<br>110 cm - ~0.18 ml |

| Item no.    | Tubing length | Soft cannula length |
|-------------|---------------|---------------------|
| 79-030-2522 | 30 cm         | 13 mm               |
| 79-060-2522 | 60 cm         | 13 mm               |
| 79-080-2522 | 80 cm         | 13 mm               |
| 79-110-2522 | 110 cm        | 13 mm               |
|             |               |                     |
| 79-060-2622 | 60 cm         | 17 mm               |
| 79-080-2622 | 80 cm         | 17 mm               |
| 79-110-2622 | 110 cm        | 17 mm               |

| Item no. - Cannula Only | Soft cannula length |
|-------------------------|---------------------|
| 76-000-2552             | 13 mm               |
| 76-000-2652             | 17 mm               |

| Item no. - Tubing Only | Tubing length |
|------------------------|---------------|
| 76-030-2652            | 30 cm         |
| 76-060-2652            | 60 cm         |
| 76-110-2652            | 110 cm        |

Each customerbox contains 10 pieces and each shipperbox contains 200 pieces.

# The neria™ soft 90 infusion set

The neria™ soft 90 infusion set is a soft cannula infusion set inserted at a 90 degree angle (straight in).

The neria™ soft 90 infusion set features a disconnect option for more flexibility and the introducer needle can be secured after use for increased needle safety.

The cannula and tubing for the neria™ soft 90 infusion set is also sold separately when either cannula or tubing needs to be changed more frequently.

The neria™ soft 90 infusion set is specifically tested for use in selected disease areas with drugs formulated for subcutaneous infusion<sup>4,5,6,7,8</sup>.

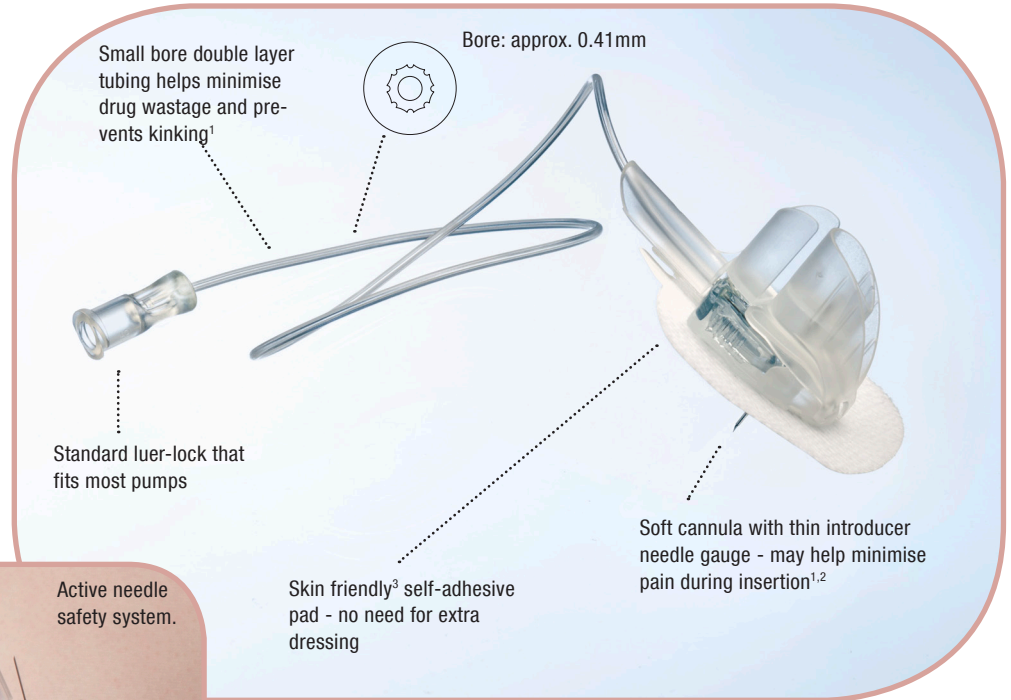

neria™ soft 90



# The neria™ soft 90 infusion set and therapy areas

The neria™ soft 90 infusion set is tested for safe use in the following disease area with drugs formulated for subcutaneous infusion<sup>4,5,6,7,8</sup>.

## Parkinson's Disease

Parkinson's Disease is a progressive neurodegenerative disorder of the central nervous system.

### Subcutaneous Infusion

Apomorphine is used subcutaneously in the treatment of Parkinson's Disease and patients normally wear the pump and set during the daytime - often 10 - 12 hours or longer.

### Infusion Set Choice

The soft and flexible cannula of the neria™ soft 90 infusion set may provide a more comfortable wear time for some patients. The thin needle design and the simple insertion technique may further help improve patient comfort and convenience.

Being easily disconnected, the neria™ soft 90 infusion set offers the patient the possibility to lead an active life despite the disease. The infusion set can be disconnected for a short period of time allowing the patient to perform activities like swimming, shopping, etc.

The 90 degree insertion angle of the neria™ soft 90 infusion set combined with the insertion handle supports the correct use of the product and makes it easier for both the healthcare provider, the patient or relatives to use.

When used in an environment where sharps containers are not available, the active needle safety system may help minimise the risk of needle injuries.

Furthermore, the small bore tubing of the neria™ soft 90 infusion set minimises drug waste<sup>1</sup> and may prolong the active day for the patient.

# The neria™ soft 90 infusion set and therapy areas

The neria™ soft 90 infusion set is tested for safe use in the following disease area with drugs formulated for subcutaneous infusion<sup>4,5,6,7,8</sup>.

## Pain Management

Pain Management of chronic pain and End of Life care (palliative care).

### Subcutaneous Infusion

In the treatment of pain the subcutaneous route is one way of delivering pain relief medication to the patient. Subcutaneous delivery of pain relief medication may be used when oral medication is no longer an option or in combination with oral medication.

### Infusion Set Choice

In palliative care, patient comfort is in focus. A soft cannula infusion set is flexible under the skin, and the 90 degree insertion technique makes it simple to use for the healthcare provider.

The somewhat larger adhesive pad makes it stick well to the skin and eliminates the need for an extra adhesive pad.

The disconnect feature and separate tubing parts are useful when changing drug regime or for the mobility of the patient, this also supports convenience during long infusion periods.

When used in an environment where sharps containers are not available, the active needle safety system may help minimise the risk of needle injuries. In the hospital setting a needle safety feature is often required. The EU sharps directive of 10 May 2010 highlights the increased focus on safe working environment for healthcare professionals through the prevention of sharps injuries. The directive was implemented by the EU member states in May 2013.

# The neria™ soft 90 infusion set - Product Specifications

|                               |   |
|-------------------------------|---|
| <b>Cannula:</b>               | Soft  |
| <b>Insertion angle:</b>       | 90 degrees (straight in)                                  |
| <b>Disconnection:</b>         | Yes at site   |
| <b>Needle gauge:</b>          | G27   |
| <b>Soft cannula diameter:</b> | 0.68 mm   |
| <b>Soft cannula lengths:</b>  | 6 or 9 mm   |
| <b>Tubing lengths:</b>        | 30, 60 or 110 cm  |
| <b>Adhesive:</b>              | Built-in  |
| <b>Priming volumes:</b>       | 30 cm - ~0.05 ml<br>60 cm - ~0.10 ml<br>110 cm - ~0.18 ml |
| <b>Needle safety:</b>         | Yes, active needle safety system                          |

| Item no.    | Tubing length | Soft cannula length |
|-------------|---------------|---------------------|
| 722030-5226 | 30 cm         | 6 mm                |
| 722030-5229 | 30 cm         | 9 mm                |
| 722060-5226 | 60 cm         | 6 mm                |
| 722060-5229 | 60 cm         | 9 mm                |
| 722110-5226 | 110 cm        | 6 mm                |
| 722110-5229 | 110 cm        | 9 mm                |

Each customerbox contains 10 pieces and each shipperbox contains 100 pieces.

| Item no. - Cannula Only | Soft cannula length |
|-------------------------|---------------------|
| 722000-5226             | 6 mm                |
| 722000-5229             | 9 mm                |

Each customerbox contains 10 pieces and each shipperbox contains 100 pieces.

| Item no. - Tubing Only | Tubing length |
|------------------------|---------------|
| 722030-5220            | 30 cm         |
| 722060-5220            | 60 cm         |
| 722110-5220            | 110 cm        |

Each customerbox contains 10 pieces and each shipperbox contains 200 pieces.

# Product Range Overview

|                         | neria™   | neria™ detach                                | neria™ multi                          | neria™ soft                                 | neria™ soft 90                           |
|-------------------------|--|--|---------------------------------------|---|--|
| <b>Cannula Material</b> |  |  |                                       |   |  |
| - Soft cannula          |  |  |                                       | ●   | ●  |
| - Steel needle          | ●  | ●  | ●                                     |   |  |
| <b>Insertion</b>        |  |  |                                       |   |  |
| - 90 degree             | ●  | ●  | ●                                     |   | ●  |
| - Angled insertion      |  |  |                                       | ●   |  |
| <b>Disconnection</b>    |  |  |                                       |   |  |
| - At site               |  |  |                                       | ●   | ●  |
| - At separate site      |  | ●  |                                       |   |  |
| <b>Adhesive</b>         |  |  |                                       |   |  |
| - Built-in              | ●  | ●  | ●                                     | ●   | ●  |
| <b>Cannula lengths</b>  | 6, 8 and 10 mm   | 6, 8 and 10 mm                               | 8, 10 and 12 mm                       | 13 mm and 17 mm                             | 6 mm and 9 mm                            |
| <b>Tubing lengths</b>   | 60, 80 and 110 cm  | 60, 80 and 110 cm                            | 90 cm                                 | 30, 60, 80 and 110 cm                       | 30, 60 and 110 cm                        |
| <b>Disease areas</b>    | Parkinson's<br>PID*<br>Pain Management<br>Thalasseamia                 | Parkinson's<br>PID*<br>Pain Management<br>-  | -<br>PID*<br>-<br>-                   | Parkinson's<br>PID*<br>Pain Management<br>- | Parkinson's<br>-<br>Pain Management<br>- |
| <b>Usage time</b>       | - Parkinson's Disease<br>- PID*<br>- Pain Management<br>- Thalasseamia | 12 hours<br>12 hours<br>48 hours<br>18 hours | 12 hours<br>12 hours<br>48 hours<br>- | -<br>12 hours<br>-<br>-                     | 12 hours<br>12 hours<br>72 hours<br>-    |

\* Primary Immune Deficiency Disease

# References

- 1 Chan G.C.F, Ng D.M.W. et al, Comparison of Subcutaneous Infusion Needles for Transfusion-Dependent Thalassemia Patients by the Intrapersonal Cross-Over Assessment Model, Am.J.Hematol.76;398-404 (2004).
- 2 Parsons J. Infusion line preferences of patients prescribed apomorphine for complex Parkinson's Disease. British Journal of Neuroscience Nursing. December 2009. Vol 5 No 12.
- 3 Biological safety testing, October 2003, Data on file, Unomedical.
- 4 Stability test and function of Comfort and Contact Detach by means of medicament APO-go. Analysis report no. 294690. April 2, 2009. Data on file. Unomedical.
- 5 Compatibility and stability testing of the catheter device Unomedical comfort™ with the immunoglobulin Subcuvia. IKFE 09016. April 16, 2009. Data on file. Unomedical.
- 6 Drug Device Stability Test Thalaset – Study Desferal (deferoxamine mesilate). July 1, 2005. Data on file. Unomedical.
- 7 Drug Compatibility Study of Three Infusion Devices with Morphine Sulfate\*, version 1.4, IKFE 10006, September 2, 2011, Data on file. Unomedical.
- 8 Drug Compatibility Study of Three Infusion Devices with Hydromorphone\* Hydrochloride, version 1.4, IKFE 10006, September 2, 2011, Data on file. Unomedical.

\* Hydromorphone is formulated for subcutaneous infusion in USA, Canada, Australia and Spain. Morphine Sulphate is formulated for subcutaneous infusion in United Kingdom, Germany and France. Morphine Chloride is formulated for subcutaneous infusion in Italy, France, Denmark, Sweden and Spain.



# ConvaTec

ConvaTec B2B is a leading manufacturer of infusion sets. Since the 1980s ConvaTec B2B, previously Unomedical, has sold millions of infusion sets world wide for use with continuous subcutaneous drug delivery. Our success is based on a high degree of innovation supported by user-friendliness and superior quality. All over the world users benefit from the ConvaTec infusion sets improving their quality of life and treatment options. Please visit [www.neria.com](http://www.neria.com) for more information on the neria™ infusion set product line, including instruction videos. ConvaTec B2B is located in Denmark and is a business unit of ConvaTec ([www.convatec.com](http://www.convatec.com)).

Distributed by: